

# PROPERTY REPORT

Property ID: **-699414141**

**Property Name:** 92 Halsey Reed Road **Ownership:** Private  
**Address:** 92 Halsey Reed RD **Apartment #:** **ZIP:** 08512

## PROPERTY LOCATION(S):

County:	Municipality:	Local Place Name:	USGS Quad:	Block:	Lot:
MIDDLESEX	Cranbury township	Cranbury	Hightstown	13	3

## Property Photo:



**Old HSI Number:**

**NRIS Number:**

**HABS/HAER Number:**

## Description:

92 Halsey Reed Road is a two-story-tall, five-bay-wide, two-bay-deep, frame dwelling built circa 1855 in the Greek Revival style. The dwelling consists of a side-gabled main block, with a two-story, rear (west) ell (added circa 1915) and a one-story, flat-roof addition extending from the rear of the ell (added circa 1955). An exterior brick chimney is located at the south gable end of the main block, and an interior brick chimney extends above the north gable end. The roof is sheathed in asphalt shingles. The exterior of the primary (east) elevation of the main block is clad in wood clapboard, while the remaining elevations are clad in vinyl siding. Windows throughout consist of one-over-one and two-over-two, vinyl-sash replacement units. Three six-over-six, double-hung, wood-sash windows survive on the second floor of the main block (historic, likely original). The primary elevation of the main block has symmetrical fenestration with a central, primary entrance containing a wood panel door with six inset lights and a transom, set into a plain wood surround (possibly historic). The central three bays on the primary elevation are sheltered by a one-story, hipped-roof porch with wood Doric columns and a bracketed wood cornice (historic, likely original). The roof of the porch is clad in tin sheets. The north and south elevations of the dwelling have asymmetrical fenestration, with two-over-two, double-hung, wood-sash windows (possibly historic) on the circa-1915 rear ell. A flat-roof, enclosed screen porch with wood Doric columns extends from the north elevation of the ell. Wood steps above a wood lattice-covered crawlspace lead to a wood screen door and an interior French door. Another secondary entrance is located in the west bay of the rear ell's south elevation, sheltered by a gable-roof portico with wood Doric columns. The rear elevation of the dwelling has asymmetrical fenestration, with two-over-two, wood-sash windows on the rear ell. The dwelling stands on a brick foundation.

Two circa-1915 outbuildings, an outhouse and a barn, are located approximately 55 feet west of the dwelling. The outhouse is capped by a wood-shingle, side-gabled roof and clad in wood plank siding with a wood batten door on its primary (south) elevation. The barn, measuring two stories tall and three bays wide, is capped by a corrugated-metal, side-gabled roof and clad in wood clapboard siding. On the primary (south) elevation, the barn features sliding and hinged wood batten doors (historic, likely original) and a large, multi-light, fixed vinyl window. The barn stands on a concrete block foundation.

A modern frame shed stands 60 feet northwest of the dwelling.

Character-defining elements of the dwelling consist of its massing, wood clapboard siding on the primary elevation, porch with a bracketed cornice, and brick gable-end chimneys.

**Survey Name:** Cranbury Historic Sites Survey Phase III

**Surveyor:** Matthew Goldberg

**Organization:** Richard Grubb & Associates, Inc.

(Primary Contact)

**Property ID:**

**-699414141**

Page 1

History: 92 Halsey Reed Road was constructed circa 1855 and is an example of a Greek Revival-style dwelling in Cranbury. The dwelling was purportedly built by the Brown family and first appears cartographically on an 1861 map of Cranbury, owned by "J. Gibson" (Walling 1861; Phillips Preiss Grygiel Leheny Hughes LLC [PPGLH] 2021:20). The dwelling appears on an 1876 map of Cranbury attributed to the same owner (Everts & Stewart 1876). "J. Gibson" is likely John Gibson, a station agent, who is listed in the 1880 federal census as residing in the subject dwelling with his wife, Margaret, and their two children (United States Bureau of the Census 1880). Around 1915, a two-story ell was added to the rear elevation of the dwelling's main block, and the extant barn and outhouse were likely constructed (Deanne Napurano, personal communication). Around 1955, a one-story addition was constructed on the rear of the ell (Nationwide Environmental Title Research [NETR] 1953, 1957). Aerial photographs from the second half of the twentieth century and into the twenty-first century depict the subject dwelling in its current footprint (NETR 1979, 1987, 1995, 2002). The property remained in the Gibson-Brown family until 1959, when Emily W. and Arnold Holmes purchased the subject dwelling (Middlesex County Clerk's Office 1959 Deed Book 2142:441). Sometime during the mid- to late twentieth century, vinyl siding was installed on all elevations except the primary elevation of the main block, and the extant windows were installed.

**Setting:**

92 Halsey Reed Road is sited on two parcels (Block 13, Lots 3 and 4) located on the west side of Halsey Reed Road in Cranbury Township, Middlesex County, New Jersey. The dwelling is oriented with its primary elevation facing east and is set back approximately 12 feet from the road. A gravel driveway leads from the roadway to the barn and a brick path leads from the rear of the dwelling to the barn. Shrubs and hardwood trees are planted in close proximity to the dwelling. A wood fence borders the front yard of the property. The subject property is located in a residential neighborhood surrounded by properties dating from the mid-nineteenth to the early twentieth centuries.

**Registration and Status Dates:**

**National Historic Landmark?:**

**National Register:**

**New Jersey Register:**

**Determination of Eligibility:**

**Certification of Eligibility:**

**SHPO Opinion:**

**Local Designation:** 12/13/2021

**Other Designation:**

**Other Designation Date:**

**Eligibility Worksheet included in present survey?**

**Is this Property an identifiable farm or former farm?**

**Location Map:**

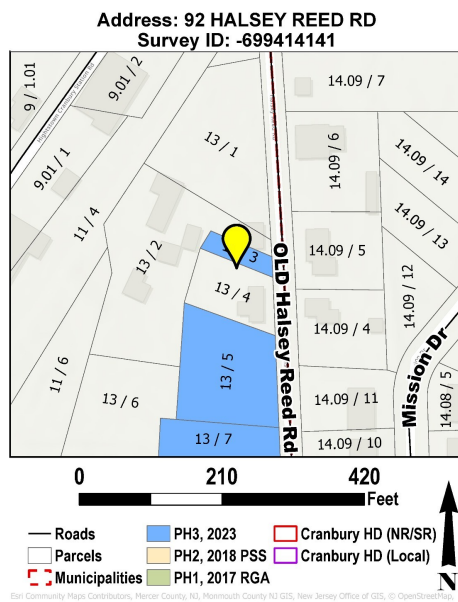

**Site Map:**

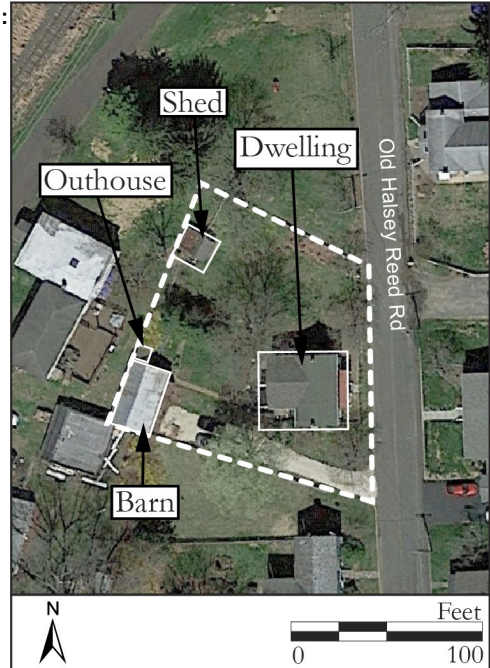

**BIBLIOGRAPHY:**

Author:	Title:	Year:	HPO Accession #:	(if applicable)
Nationwide Environmental Title Research	Historic Aerial Photograph. Electronic document, <a href="http://www.historicaerials.com">http://www.historicaerials.com</a> , accessed June 2023.	2002		
Phillips Preiss Grygiel Leheny Hughes LLC (PPGLH)	Designation of the Cranbury Station Hamlet Historic District. Prepared for the Township of Cranbury and The Historic Preservation Commission. On file, State Historic Preservation Office, Trenton, New Jersey.	2021		
United States Bureau of the Census	Population Schedule, Township of Cranbury, Middlesex County, New Jersey.	1880		
Walling, H.F.	Map of Middlesex County, New Jersey. Smith, Gallup & Co., New York, New York.	1861		

**Survey Name:** Cranbury Historic Sites Survey Phase III

**Surveyor:** Matthew Goldberg

**Organization:** Richard Grubb & Associates, Inc.

(Primary Contact)

**Property ID:**

**-699414141**

Page 2

Everts & Stewart	Combination Atlas Map of Middlesex County, New Jersey. Everts & Stewart, Philadelphia, Pennsylvania.	1876
Middlesex County Clerk's Office	On file, Middlesex County Clerk's Office, New Brunswick, New Jersey.	
Nationwide Environmental Title Research	Historic Aerial Photograph. Electronic document, <a href="http://www.historicaerials.com">http://www.historicaerials.com</a> , accessed June 2023.	1953
Nationwide Environmental Title Research	Historic Aerial Photograph. Electronic document, <a href="http://www.historicaerials.com">http://www.historicaerials.com</a> , accessed June 2023.	1957
Nationwide Environmental Title Research	Historic Aerial Photograph. Electronic document, <a href="http://www.historicaerials.com">http://www.historicaerials.com</a> , accessed June 2023.	1979
Nationwide Environmental Title Research	Historic Aerial Photograph. Electronic document, <a href="http://www.historicaerials.com">http://www.historicaerials.com</a> , accessed June 2023.	1987
Nationwide Environmental Title Research	Historic Aerial Photograph. Electronic document, <a href="http://www.historicaerials.com">http://www.historicaerials.com</a> , accessed June 2023.	1995

**Additional Information:**

92 Halsey Reed Road was identified in the 2021 Designation of the Cranbury Station Hamlet Historic District and evaluated as a contributing resource under Criterion C (PPGLH 2021:19). Richard Grubb & Associates, Inc. recommends 92 Halsey Reed Road as a contributing resource to the Cranbury Historic District due to its date of construction and design. The dwelling retains sufficient integrity of materials, design, workmanship, setting, location, feeling, and association to convey the significance of the historic district.

**More Research Needed?**  (checked=Yes)

**INTENSIVE-LEVEL USE ONLY:**

**Attachments Included:**

0 Building	0 Bridge
0 Structure	0 Landscape
0 Object	0 Industry

**Historic District ?**

**District Name:** Cranbury Station Hamlet Historic District

**Status:** Contributing

**Associated Archeological Site/Deposits?**

(known or potential sites. If Yes, please describe briefly)

Conversion Problem?  ConversionNote: 1202\_13\_3

Date form completed: 6/21/2023

**Survey Name:** Cranbury Historic Sites Survey Phase III

**Surveyor:** Matthew Goldberg

**Organization:** Richard Grubb & Associates, Inc.

(Primary Contact)

**Property ID:**

**-699414141**

Page 3



**PROPERTY REPORT: PHOTO CONTINUATION SHEET**

Property ID: -699414141

**Property Name:** 92 Halsey Reed Road

**Address:** 92 Halsey Reed RD



*Photo 2*



*Photo 3*



Property Name: 92 Halsey Reed Road

Address: 92 Halsey Reed RD



Photo 4



Photo 5



Property Name: 92 Halsey Reed Road

Address: 92 Halsey Reed RD



Photo 6