

PROPERTY REPORT

Property ID: **-572686700**

Property Name: 36 Station Road **Ownership:** Private
Address: 36 Station RD **Apartment #:** **ZIP:** 08512

PROPERTY LOCATION(S):

County:	Municipality:	Local Place Name:	USGS Quad:	Block:	Lot:
MIDDLESEX	Cranbury township	Cranbury	Hightstown	18	20.22

Property Photo:



Old HSI Number:

NRIS Number:

HABS/HAER Number:

Description:

36 Station Road is a two-story-tall, five-bay-wide, frame dwelling constructed circa 1985 in the New Traditional Colonial Revival style. The dwelling consists of a side-gabled main block, a one-story, side-gabled west wing, and a one-and-one-half-story, front-gabled garage attached to the west elevation of the west wing (constructed circa 2000). Asphalt shingles cover the roof throughout. The rooflines of the main block and west wing are accented by a dentillated frieze board. An off-center, exterior, brick chimney abuts the east elevation of the main block. The exterior of the dwelling is clad in vinyl siding. Windows are all one-over-one, vinyl-sash units. The primary (north) elevation has symmetrical fenestration with inoperable, vinyl louvered shutters flanking the windows. Wood lintels cap the first-floor windows on the main block. Located in the center bay of the main block, the primary entrance is recessed and consists of a paneled wood door with glazing flanked by wood sidelights. Framing the entrance bay is a wood surround with pilasters beneath a dentillated frieze board. A one-story, flat-roof porch supported by wood Doric columns shelters the central three bays of the main block. The east and west elevations of the main block are devoid of openings. The west wing contains symmetrically placed vinyl-sash windows flanked by inoperable, vinyl louvered shutters on the primary elevation. The attached garage contains a centered, paneled vinyl roll-top garage door on the primary elevation and a single vinyl-sash window in the gable peak. The rear (south) elevation is not visible from the public right-of-way.

A circa-2000 one-story, frame shed stands approximately eight feet southeast of the dwelling.

History: 36 Station Road was constructed circa 1985 and is an example of a late twentieth-century, New Traditional Colonial Revival-style dwelling in Cranbury. The subject dwelling was likely constructed by MECCA Development corporation around 1985 (Nationwide Environmental Title Research [NETR] 1984; Middlesex County Clerk's Office 1985 Deed Book 3444:49). The dwelling first appears on a 1987 aerial photograph, with the main block and west wing depicted (NETR 1987). Around 2000, a one-and-one-half-story-tall garage was constructed adjacent to the west wing of the dwelling, and a one-story shed was added to the property (NETR 1995, 2002).

Setting:

36 Station Road is sited on a roughly rectangular-shaped parcel (Block 18, Lot 20.22) located on the south side of Station Road in Cranbury Township, Middlesex County, New Jersey. The dwelling is oriented with its primary elevation facing north and is set back approximately 71 feet from the road. An asphalt-paved driveway extends south from Station Road to the attached garage on the west wing. Mature trees and shrubs are planted within close proximity to the dwelling. The subject dwelling is located in a residential

Survey Name: Cranbury Historic Sites Survey Phase III

Surveyor: Spencer Rubino

Organization: Richard Grubb & Associates, Inc.

(Primary Contact)

Property ID:

-572686700

Page 1

neighborhood surrounded by properties generally dating from the mid-nineteenth to the late twentieth centuries.

Registration and Status Dates:

National Historic Landmark?:
National Register: 9/18/1980
New Jersey Register: 8/9/1979
Determination of Eligibility: 3/25/1977
Certification of Eligibility:

SHPO Opinion:
Local Designation: 9/26/1988
Other Designation:
Other Designation Date:

Eligibility Worksheet included in present survey? **Is this Property an identifiable farm or former farm?**

Location Map:

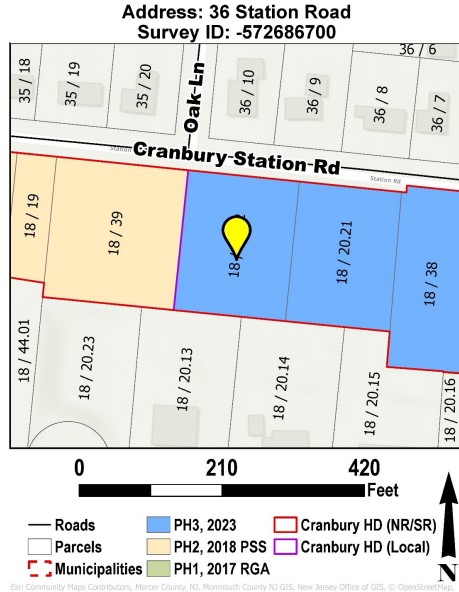

Site Map:



BIBLIOGRAPHY:

Author:	Title:	Year:	HPO Accession #: (if applicable)
Middlesex County Clerk's Office	On file, Middlesex County Clerk's Office, New Brunswick, New Jersey.		
Nationwide Environmental Title Research (NETR)	Historic Aerial Photograph. Electronic document, https://www.historicaerials.com , accessed May 2023.	1984	
Nationwide Environmental Title Research (NETR)	Historic Aerial Photograph. Electronic document, https://www.historicaerials.com , accessed May 2023.	1987	
Nationwide Environmental Title Research (NETR)	Historic Aerial Photograph. Electronic document, https://www.historicaerials.com , accessed May 2023.	1995	
Nationwide Environmental Title Research (NETR)	Historic Aerial Photograph. Electronic document, https://www.historicaerials.com , accessed May 2023.	2002	

Additional Information:

Richard Grubb & Associates, Inc. recommends 36 Station Road as a non-contributing resource to the Cranbury Historic District due to its date of construction.

More Research Needed? (checked=Yes)

INTENSIVE-LEVEL USE ONLY:

Attachments Included:

0 Building	0 Bridge
0 Structure	0 Landscape
0 Object	0 Industry

Historic District ?

District Name: Cranbury Historic District

Status: Non Contributing

Survey Name: Cranbury Historic Sites Survey Phase III

Surveyor: Spencer Rubino

Organization: Richard Grubb & Associates, Inc.

(Primary Contact)

Property ID:

-572686700

Associated Archeological Site/Deposits?
(known or potential sites. If Yes, please describe briefly)

Conversion Problem? ConversionNote: 1202_18_20.22

Date form completed: 6/21/2023

Survey Name: Cranbury Historic Sites Survey Phase III

Surveyor: Spencer Rubino

Organization: Richard Grubb & Associates, Inc.

(Primary Contact)

Property ID:

-572686700

Page 3

PROPERTY REPORT: PHOTO CONTINUATION SHEET

Property ID: **-572686700**

Property Name: 36 Station Road

Address: 36 Station RD



Photo 2



Photo 3