

PROPERTY REPORT

Property ID: **1516857096**

Property Name: 69-71 North Main Street **Ownership:** Private
Address: 69-71 N Main ST **Apartment #:** **ZIP:** 08512

PROPERTY LOCATION(S):

County:	Municipality:	Local Place Name:	USGS Quad:	Block:	Lot:
MIDDLESEX	Cranbury township	Cranbury	Hightstown	23	45.02

Property Photo:



Old HSI Number: **NRIS Number:** **HABS/HAER Number:**

Description:

69-71 North Main Street is a two-part building consisting of a two-story, three-bay, two-pile south section and a one-story, two-bay, three-pile north section, aligned on the main (east) elevation.

The larger south section (69 North Main Street) was constructed circa 1842. Its side gabled roof is sheathed with asphalt shingles and features an attached (exterior) chimney on the south end. The house has a molded cornice but no returns on the end walls. The house's frame walls are clad with wood clapboard siding. Fenestration consists of two-over-two vinyl-sash within molded wood surrounds, flanked by louvered, inoperable shutters. The entrance is located in the north bay of the main elevation, below a front porch that extends along the front of the addition. The door is a paneled unit with six lights above four panels and opens below a four-pane transom. It has a historic screen door that appears to date to the late nineteenth century. The porch is a one-story element with a shed roof supported by four replacement turned columns. The porch floor is one step above the grade of the sidewalk. The house has a stone foundation.

The south end of 69 North Main Street is frame and clad with composite wood shingles. The attached brick chimney is a major element of this elevation. Fenestration is mostly symmetrically arranged, but window details are obscured by large awnings. The attic level has a centered window, and the second floor has two windows; each of these windows features flanking paneled shutters. The first floor has a picture window east of the chimney with undersized paneled shutters.

Survey Name: Cranbury CLG Survey 2017

Surveyor: Kristen Herrick

Organization: RGA, Inc.

Property ID:

1516857096

Page 1

(Primary Contact)

71 North Main Street is the north section of the building. It has an end-gabled roof with an asymmetrical gable, clad with asphalt shingles. The frame walls are clad with wood clapboards. The entrance is located in the south bay, opening onto the front porch described above. The door is a paneled wood unit with six inset lights over four panels and a historic screen door. North of the door is a paired two-over-two vinyl sash (replacement) window flanked by undersized, louvered shutters.

The north elevation of 71 North Main Street is clad with composite wood shingles. Fenestration is highly asymmetrical. Windows are one-over-one (replacement) units, arranged on two floor levels. The size and shapes of the windows varies widely, with two sets of paired units.

The two sections of the building have one-story rear additions, none of which are visible from the public right-of-way.

History: The 1916 Sanborn Atlas shows the two sections facing onto North Main Street and a rear addition on each section. The 1933 Sanborn Atlas shows the same features of the house. An outbuilding shown on these two Sanborn Atlases was demolished in the 1930s to create space for the construction of 67 North Main Street. All historic aerial photographs show the two main sections of the house and its rear additions. Gil & Bert's Ice Cream has operated at 69-71 North Main Street since 2007.

Setting:

69-71 North Main Street is sited on an L-shaped parcel (Block 23, Lot 45.02) located on the west side of North Main Street in Cranbury Township, Middlesex County, New Jersey. The building is oriented with its primary elevation facing southeast and is set back approximately 10 feet from North Main Street. A brick and concrete sidewalk spans the west side of the parcel. A loose gravel driveway leads west from North Main Street to the rear of the property. The property is lightly wooded. 69-71 North Main Street is located in a mixed residential and commercial neighborhood surrounded by commercial and residential properties dating from the mid-nineteenth to the early twentieth centuries.

Registration and Status Dates:

National Historic Landmark?:
National Register: 9/18/1980
New Jersey Register: 8/9/1979
Determination of Eligibility: 3/25/1977
Certification of Eligibility:

SHPO Opinion:
Local Designation: 9/26/1988
Other Designation:
Other Designation Date:

Eligibility Worksheet included in present survey? Is this Property an identifiable farm or former farm?

Location Map:

Site Map:

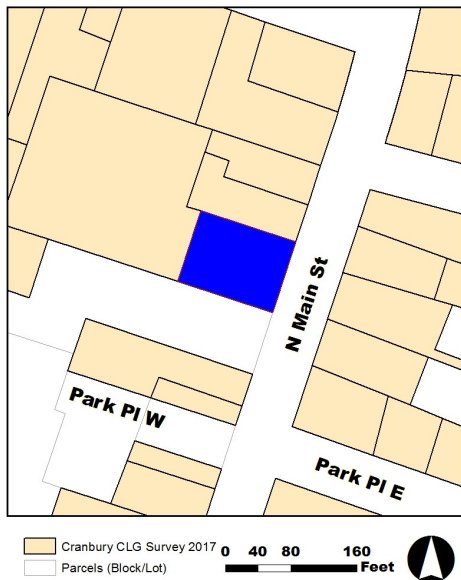

Survey Name: Cranbury CLG Survey 2017
Surveyor: Kristen Herrick
Organization: RGA, Inc.

(Primary Contact) **Property ID:** 1516857096

BIBLIOGRAPHY:

Author:	Title:	Year:	HPO Accession #:	(if applicable)
Walsh, Ruth	National Register of Historic Places Nomination for the Cranbury Historic District, Cranbury Township, Middlesex County, New Jersey	1979		
Heritage Studies	Preserving Historic Cranbury Village	1989		

Additional Information:

The 1989 Heritage Studies survey identified 69-71 North Main Street as a contributing resource to the Cranbury Historic District. RGA concurs with the previous evaluation and recommends 69-71 North Main Street as a contributing resource due to its date of construction and design.

More Research Needed? (checked=Yes)

INTENSIVE-LEVEL USE ONLY:

Attachments Included:

0 Building	0 Bridge
0 Structure	0 Landscape
0 Object	0 Industry

Historic District ?

District Name: Cranbury Historic District

Status: Contributing

Associated Archeological Site/Deposits?

(known or potential sites. If Yes, please describe briefly)

Conversion Problem? ConversionNote: 25

Date form completed: 7/25/2017

Survey Name: Cranbury CLG Survey 2017

Surveyor: Kristen Herrick

Organization: RGA, Inc.

(Primary Contact)

Property ID:

1516857096