

## PROPERTY REPORT

Property ID: **-180588270**

**Property Name:** Princeton Ballet School      **Ownership:** Private  
**Address:** 29 N Main ST      **Apartment #:**      **ZIP:** 08512

### PROPERTY LOCATION(S):

County:	Municipality:	Local Place Name:	USGS Quad:	Block:	Lot:
MIDDLESEX	Cranbury township	Cranbury	Hightstown	23	59

### Property Photo:



**Old HSI Number:**

**NRIS Number:**

**HABS/HAER Number:**

### Description:

Princeton Ballet School at 29 North Main Street is a one-story tall, four-bay wide, thirteen-bay deep, rusticated concrete block commercial building constructed in 1922. The building, which sits on a concrete foundation, has a rectangular footprint and no additions. The front-gabled roof is sheathed with asphalt shingles and has a stepped parapet on the front elevation. The exterior of the building is clad in Hardi-Plank siding on the front elevation while the side and rear elevations have exposed rusticated concrete blocks. Windows on the front elevation are three large picture replacement windows with two smaller, fixed replacement windows above each unit. The three-part entrance, located in the south bay, consists of a single door with one large pane between two fixed windows the same size and shape as the door. The entrance is topped by three smaller, fixed replacement windows. The tripartite entrance consists of a central glass door between two picture windows. Access is gained via a concrete stoop with brick steps and metal railings. The side elevations are similar in appearance with six-over-six, vinyl-sash replacement windows spaced evenly across the façade. The rear elevation has a secondary entrance in the south corner (a single door framed by three picture windows) and ghost marks of a filled-in garage door in the center of the façade. The stepped parapet is a character-defining feature of the building.

**History:** Princeton Ballet School at 29 North Main Street was constructed in 1922 as an automobile garage called Central Garage (Chambers 2012:122-123). The subject building first appears cartographically on the 1933 Sanborn map of Cranbury Township as a one-story, rectangular concrete block building. The subject building served as a garage throughout the twentieth century. In 2011, the front

**Survey Name:** Cranbury CLG Survey 2017

**Surveyor:** Kristen Herrick

**Organization:** RGA, Inc.

**Property ID:**

**-180588270**

Page 1

(Primary Contact)

elevation of the subject building was extensively altered. These renovations included the addition of Hardi-Plank siding and the replacement of the windows. The subject building currently serves as the Cranbury branch of American Repertory Ballet's Princeton Ballet School.

**Setting:**

Princeton Ballet School at 29 North Main Street is sited on a rectangular parcel (Block 23, Lot 59) located on the west side of North Main Street in Cranbury Township, Middlesex County, New Jersey. The building is oriented with its primary elevation facing southeast and is set back approximately 15 feet from North Main Street. A concrete sidewalk, which runs along North Main Street, spans the east side of the parcel. A concrete sidewalk leads west past the southwest elevation of the building to a paved parking lot located to the rear of the building. 29 North Main Street is located in a mixed residential and commercial neighborhood surrounded by properties dating from the mid-nineteenth to the early twentieth century.

**Registration and Status Dates:**

**National Historic Landmark?:**   
**National Register:** 9/18/1980  
**New Jersey Register:** 8/9/1979  
**Determination of Eligibility:** 3/25/1977  
**Certification of Eligibility:**

**SHPO Opinion:**  
**Local Designation:** 9/26/1988  
**Other Designation:**  
**Other Designation Date:**

Eligibility Worksheet included in present survey?       Is this Property an identifiable farm or former farm?

**Location Map:**

**Site Map:**

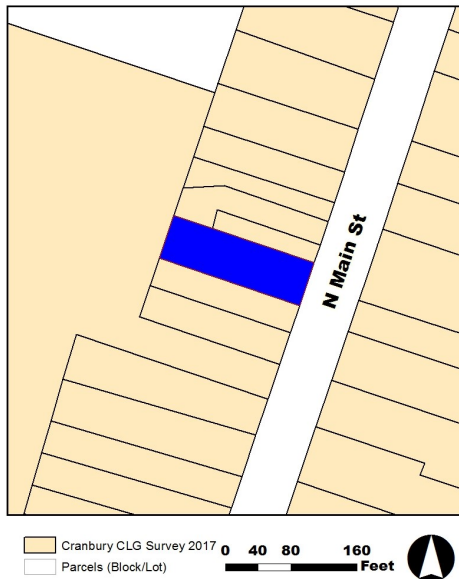

**BIBLIOGRAPHY:**

Author:	Title:	Year:	HPO Accession #:
Chambers, John Whiteclay II	Cranbury: A New Jersey Town from the Colonial Era to the Present	2012	(if applicable)
Walsh, Ruth	National Register of Historic Places Nomination for the Cranbury Historic District, Cranbury Township, Middlesex County, New Jersey	1979	
Heritage Studies	Preserving Historic Cranbury Village	1989	

**Additional Information:**

The 1989 Heritage Studies survey identified Princeton Ballet School at 29 North Main Street as a contributing resource to the Cranbury Historic District. RGA concurs with the previous evaluation and recommends Princeton Ballet School at 29 North Main Street as a

**Survey Name:** Cranbury CLG Survey 2017

**Surveyor:** Kristen Herrick

**Organization:** RGA, Inc.

**Property ID:**

Page 2

(Primary Contact)

**-180588270**

contributing resource due to its date of construction.

**More Research Needed?**  (checked=Yes)

---

**INTENSIVE-LEVEL USE ONLY:**

**Attachments Included:**          0 Building                                  0 Bridge  
    0 Structure                                  0 Landscape  
    0 Object    0 Industry

**Historic District ?**

**District Name:** Cranbury Historic District

**Status:** Contributing

**Associated Archeological Site/Deposits?**

(known or potential sites. If Yes, please describe briefly)

---

Conversion Problem?           ConversionNote: 47

*Date form completed:* 6/26/2017

---

**Survey Name:** Cranbury CLG Survey 2017

**Surveyor:** Kristen Herrick

**Organization:** RGA, Inc.

**Property ID:**

(Primary Contact)

**-180588270**

Page 3