

PROPERTY REPORT

Property ID: **-893430922**

Property Name: 8 Cranbury Neck Road **Ownership:** Private
Address: 8 Cranbury Neck RD **Apartment #:** **ZIP:** 08512

PROPERTY LOCATION(S):

County:	Municipality:	Local Place Name:	USGS Quad:	Block:	Lot:
MIDDLESEX	Cranbury township	Cranbury	Hightstown	23	93

Property Photo:



Old HSI Number:

NRIS Number:

HABS/HAER Number:

Description:

8 Cranbury Neck Road is a two-and-one-half-story-tall, three-bay-wide, two-bay-deep, frame dwelling built circa 1928 in the Dutch Colonial Revival style. The dwelling consists of a gambrel-roof main block with a one-story, hipped-roof wing on the southeast elevation and a one-story, shed-roof wing on the rear (north) elevation. The roof is clad in asphalt shingles and is accented by a molded wood cornice. Full-length, shed-roof dormers extend across the primary (south) and rear slopes of the main block's roof. An exterior brick chimney is located on the southeast elevation of the main block. The exterior of the dwelling is covered in stucco (historic, likely original). Windows are all single and grouped, six-over-one, wood-sash units, set within wood surrounds with slightly molded lintels (historic, likely original) with aluminum storm windows. Located in the westernmost bay on the primary elevation, the primary entrance contains a six-light, wood Dutch door with a metal storm door and segmented vinyl sidelights. Above the door, there is a semicircular, wood transom with a sunburst motif (historic, likely original). The entrance is sheltered by a gabled hood with a molded wood cornice (historic, likely original) and is accessed by a concrete and brick stoop with metal railings. The east and west elevations of the main block have a symmetrical fenestration, with wood-sash windows in the gambrel ends and a pent roof sheltering the first floor. The west elevation features a central, secondary entrance containing a wood door with a metal storm door. The east wing has symmetrical fenestration on its primary and east elevations. The rear elevation of the dwelling is not visible from the public right-of-way. The dwelling stands atop a parged foundation, with two-light hopper windows at the basement level visible on the primary and west elevations.

A one-story-tall, two-bay-wide, frame garage, constructed circa 1928, stands approximately 45 feet to the north of the dwelling. The exterior is clad in wood plank siding and the roof is sheathed in asphalt shingles. The primary (south) elevation features two double-leaf, paneled wood doors with twelve inset lights.

Character-defining elements of the dwelling include its massing, gambrel roof, full-length shed-roof dormers, wood-sash windows, molded wood cornice, and gabled hood with sunburst motif.

History: 8 Cranbury Neck Road was constructed circa 1928 and is an example of an early twentieth-century, Dutch Colonial Revival-style dwelling in Cranbury. During the nineteenth century, the subject property was part of a large farm known as the Parsonage Farm, owned by the First Presbyterian Church of Cranbury. In 1928, the First Presbyterian Congregation of New Jersey sold the subject property as an undeveloped lot to Eva M. Applegate (Middlesex County Clerk's Office 1928 Deed Book 967:271). The 1928 deed specified that a dwelling

Survey Name: Cranbury Historic Sites Survey Phase III

Surveyor: Matthew Goldberg

Organization: Richard Grubb & Associates, Inc.

(Primary Contact)

Property ID:

-893430922

Page 1

should be built on the lot within two years of the purchase date. The subject dwelling was likely constructed shortly after Eva's purchase and first appears on a 1930 aerial photograph, accompanied by a detached garage to the north New Jersey Department of Environmental Protection 1930). The 1930 federal census lists Eva, her husband, Harold C. Applegate, and their three sons as residents of the subject dwelling (United States Bureau of the Census [US Census] 1930). Harold C. Applegate served in the U.S. Air Service in World War I and went on to serve as an electrician at the Lakehurst Naval Air Station before working as an auto mechanic US Census 1930; The Central New Jersey Home News, 26 December 1967:30). A 1933 Sanborn map of Cranbury depicts the subject dwelling and garage in their current footprints (Sanborn Map Company 1933). With the exception of replacement of roof cladding materials, the subject dwelling appears to have undergone little to no major alterations in the decades since its construction (Nationwide Environmental Title Research 1957, 1979, 1995, 2019).

Setting:

8 Cranbury Neck Road is sited on a rectangular parcel (Block 23, Lot 93) located on the north side of Cranbury Neck Road in Cranbury Township, Middlesex County, New Jersey. The dwelling is oriented with its primary elevation facing south and is set back approximately 30 feet from the road. An asphalt driveway extends along the west border of the property and leads to the garage. Shrubs are planted within close proximity to the dwelling. A concrete sidewalk bounds the south border of the property and a concrete path leads to the primary entrance. The subject property is located in a residential neighborhood surrounded by properties dating from the mid-nineteenth to the early twentieth centuries.

Registration and Status Dates:
National Historic Landmark?:
National Register: 9/18/1980
New Jersey Register: 8/9/1979
Determination of Eligibility: 3/25/1977
Certification of Eligibility:

SHPO Opinion:
Local Designation: 9/26/1988
Other Designation:
Other Designation Date:

Eligibility Worksheet included in present survey? Is this Property an identifiable farm or former farm?

Location Map:

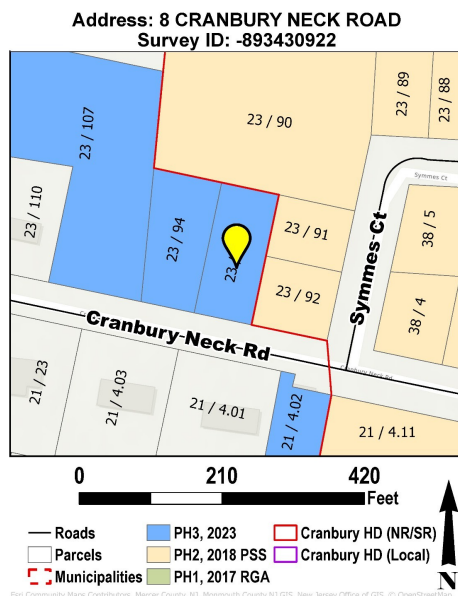

Site Map:



BIBLIOGRAPHY:

Author:	Title:	Year:	HPO Accession #:	(if applicable)
The Central New Jersey Home News	Harold C. Applegate. 26 December:30. New Brunswick, New Jersey.	1967		
Middlesex County Clerk's Office	On file, Middlesex County Clerk's Office, New Brunswick, New Jersey.			
New Jersey Department of Environmental Protection	NJ-GeoWeb. Electronic Document, https://www.nj.gov/dep/gis/geoweb splash.htm , accessed April 2023.	1930		
Nationwide Environmental Title Research (NETR)	Historic Aerial Photograph, Electronic document, www.historicaerials.com , accessed June 2023.	1957		
Nationwide Environmental Title Research (NETR)	Historic Aerial Photograph, Electronic document, www.historicaerials.com , accessed June 2023.	1979		
Nationwide	Historic Aerial Photograph, Electronic document,	1995		

Survey Name: Cranbury Historic Sites Survey Phase III

Surveyor: Matthew Goldberg

Organization: Richard Grubb & Associates, Inc.

(Primary Contact)

Property ID:

-893430922

Page 2

Environmental Title Research	www.historicaerials.com, accessed June 2023.	
Nationwide Environmental Title Research (NETR)	Historic Aerial Photograph, Electronic document, www.historicaerials.com, accessed June 2023.	2019
Sanborn Map Company	Insurance Maps of Cranbury, Middlesex County, New Jersey. Sanborn Map Company, New York, New York.	1933
United States Bureau of the Census (US Census)	Population Schedule, Township of Cranbury, Middlesex County, New Jersey.	1930

Additional Information:

Richard Grubb & Associates, Inc. recommends 8 Cranbury Neck Road as a contributing resource to the Cranbury Historic District due to its date of construction and design. The dwelling retains sufficient integrity of materials, design, workmanship, setting, location, feeling, and association to convey the significance of the historic district.

More Research Needed? (checked=Yes)

INTENSIVE-LEVEL USE ONLY:

Attachments Included:

0 Building	0 Bridge
0 Structure	0 Landscape
0 Object	0 Industry

Historic District ?

District Name: Cranbury Historic District

Status: Contributing

Associated Archeological Site/Deposits?

(known or potential sites. If Yes, please describe briefly)

Conversion Problem? ConversionNote: 1202_23_93

Date form completed: 6/21/2023

Survey Name: Cranbury Historic Sites Survey Phase III

Surveyor: Matthew Goldberg

Organization: Richard Grubb & Associates, Inc.

(Primary Contact)

Property ID:

-893430922

PROPERTY REPORT: PHOTO CONTINUATION SHEET

Property ID: **-893430922**

Property Name: 8 Cranbury Neck Road
Address: 8 Cranbury Neck RD



Photo 2



Photo 3

Property Name: 8 Cranbury Neck Road
Address: 8 Cranbury Neck RD



Photo 4