

PROPERTY REPORT

Property ID: **1226915908**

Property Name: 2 Barclay Street **Ownership:** Private
Address: 2 Barclay ST **Apartment #:** **ZIP:** 08512

PROPERTY LOCATION(S):

County:	Municipality:	Local Place Name:	USGS Quad:	Block:	Lot:
MIDDLESEX	Cranbury township	Cranbury	Hightstown	25	24

Property Photo:



Old HSI Number:

NRIS Number:

HABS/HAER Number:

Description:

2 Barclay Street is a two-story-tall, three-bay-wide, three-bay-deep, frame dwelling built circa 1929 as a one-story Bungalow and raised to two stories in the 1980s. The dwelling consists of a front-gabled main block and a one-story-tall, three-bay-wide, gable-roof addition on the rear (northeast) elevation (built circa 2019). An exterior brick chimney extends above the northwest elevation and an interior brick chimney pierces the roof ridge of the main block. The roof is sheathed in asphalt shingles. The exterior of the dwelling is clad in vinyl siding, with vinyl board and batten on the first floor of the primary (southwest) and northwest elevations. Windows generally consist of single and paired, vinyl-sash replacement units set within vinyl surrounds. The central, primary entrance contains a wood panel door with three lights (possibly original). A one-story, wraparound porch extends along the primary and northwest elevations (built circa 2019). The porch has a hipped roof covered with standing-seam metal panels and is supported by square vinyl posts. Vinyl railings flank the central stairway providing access to the porch. Centered on the southeast elevation is a one-and-one-half-story, front-gabled projecting bay. A secondary entrance is located on the southeast elevation of the rear addition. Sheltered by a front-gabled portico and accessed by a small wood deck, it contains a metal storm door and a modern wood door. The rear elevation is not visible from the public right-of-way. The dwelling stands atop a parged foundation.

A one-story-tall, one-bay-wide, frame garage, built circa 1935, is located approximately 25 feet northwest of the dwelling. Capped with an asphalt-shingle, front-gabled roof, the garage is clad in vinyl siding. A single, metal roll-top door is centered on the primary (southwest) elevation.

History: 2 Barclay Street was constructed circa 1929 and is an example of an early twentieth-century vernacular dwelling in Cranbury. In 1929, Ernest E. Campbell purchased the subject property as an empty lot from Ezekiel S. Barclay (Middlesex County Clerk's Office 1929 Deed Book 963:201). The subject dwelling, originally a one-story Bungalow, was likely constructed shortly thereafter (Cranbury Historic Preservation Commission 2023). The 1930 federal census lists Ernest Campbell, his wife, Mary, and their two children as residents of the subject dwelling. Campbell was employed as a life insurance agent (United States Census Bureau 1930). The dwelling first appears on a 1930 aerial photograph in nearly its current footprint, with a one-story, hipped-roof porch on the primary elevation and the garage first appears clearly on a 1940 photograph (New Jersey Department of Environmental Protection 1930; Nationwide Environmental Title [NETR] 1940). During the 1980s, the dwelling was raised to its current two-story height (Cranbury Historic Preservation Commission 2023). By 2019, the shed-roof porch was replaced by a larger wraparound porch and a one-story addition was constructed on the rear elevation of

Survey Name: Cranbury Historic Sites Survey Phase III

Surveyor: Matthew Goldberg

Organization: Richard Grubb & Associates, Inc.

(Primary Contact)

Property ID:

1226915908

Page 1

the dwelling (Google 2019). The current siding and windows were also likely installed around 2019.

Setting:

2 Barclay Street is sited on a rectangular parcel (Block 25, Lot 24) located on the northwest of the side of Barclay Street in Cranbury Township, Middlesex County, New Jersey. The dwelling is oriented with its primary elevation facing southwest and is set back approximately 45 feet from the road. An asphalt driveway extends along the southeast border of the property and leads to the detached garage. A brick path leads from the roadway to the primary entrance. Shrubs are planted within close proximity to the dwelling. The subject property is located in a residential neighborhood surrounded by properties dating from the mid-nineteenth to the late twentieth centuries.

Registration and Status Dates:

National Historic Landmark?:
National Register: 9/18/1980
New Jersey Register: 8/9/1979
Determination of Eligibility: 3/25/1977
Certification of Eligibility:

SHPO Opinion:
Local Designation: 9/26/1988
Other Designation:
Other Designation Date:

Eligibility Worksheet included in present survey? Is this Property an identifiable farm or former farm?

Location Map:

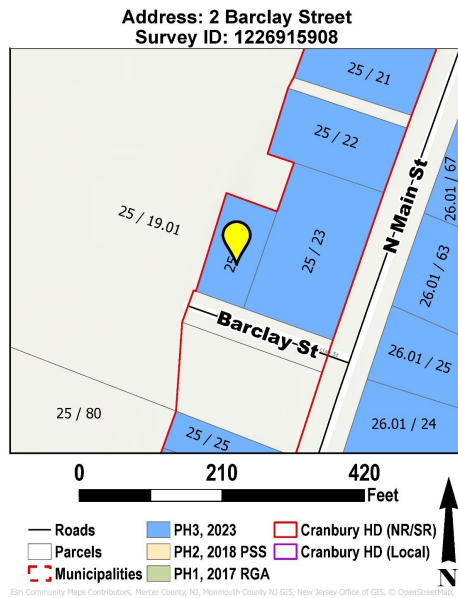

Site Map:



BIBLIOGRAPHY:

Author:	Title:	Year:	HPO Accession #: (if applicable)
Cranbury Historic Preservation Commission	Meeting with the Cranbury Historic Preservation Commission, August 1, 2023.	2023	
Google	Google Street View. Electronic document, www.maps.google.com, accessed June 2023.	2019	
Heritage Studies	Preserving Historic Cranbury Village. Prepared for the Cranbury Township Historic Preservation Advisory Committee.	1989	
Middlesex County Clerk's Office	On file, Middlesex County Clerk's Office, New Brunswick, New Jersey.		
Nationwide Environmental Title Research (NETR)	Historic Aerial Photograph. Electronic Document, http://www.historicaerials.com, accessed May 2023.	1940	
New Jersey Department of Environmental Protection	NJ-GeoWeb. Electronic Document, https://www.nj.gov/dep/gis/geoweb splash.htm, accessed March 2023.	1930	
United States Bureau of the Census	Population Schedule, Township of Cranbury, Middlesex County, New Jersey.	1930	
Walsh, Ruth	National Register of Historic Places Nomination Form for the Cranbury Historic District, Township of Cranbury, Middlesex County, New Jersey. On file, New Jersey	1980	

Survey Name: Cranbury Historic Sites Survey Phase III

Surveyor: Matthew Goldberg

Organization: Richard Grubb & Associates, Inc.

(Primary Contact)

Property ID:

1226915908

Page 2

Additional Information:

The dwelling at 2 Barclay Street was identified in the 1980 Cranbury Historic District National Register of Historic Places nomination and evaluated as a potential contributing resource in the 1989 Heritage Studies inventory of the district (Walsh 1980; Heritage Studies 1989). Richard Grubb & Associates, Inc. recommends 2 Barclay Street as a non-contributing resource to the Cranbury Historic District due to its low integrity of materials, design, and workmanship.

More Research Needed? (checked=Yes)

INTENSIVE-LEVEL USE ONLY:

Attachments Included:

0 Building	0 Bridge
0 Structure	0 Landscape
0 Object	0 Industry

Historic District ?

District Name: Cranbury Historic District

Status: Non Contributing

Associated Archeological Site/Deposits?

(known or potential sites. If Yes, please describe briefly)

Conversion Problem? ConversionNote: 1202_25_24

Date form completed: 6/21/2023

Survey Name: Cranbury Historic Sites Survey Phase III

Surveyor: Matthew Goldberg

Organization: Richard Grubb & Associates, Inc.

(Primary Contact)

Property ID:

1226915908

Page 3

PROPERTY REPORT: PHOTO CONTINUATION SHEET

Property ID: 1226915908

Property Name: 2 Barclay Street
Address: 2 Barclay ST



Photo 2



Photo 3

Property Name: 2 Barclay Street
Address: 2 Barclay ST



Photo 4