

PROPERTY REPORT

Property ID: **-1236494288**

Property Name: George Farr Farm **Ownership:** Private
Address: 158 N Main ST **Apartment #:** **ZIP:** 08512

PROPERTY LOCATION(S):

County:	Municipality:	Local Place Name:	USGS Quad:	Block:	Lot:
MIDDLESEX	Cranbury township	Cranbury	Highstown	26	30

Property Photo:



Old HSI Number:

NRIS Number:

HABS/HAER Number:

Description:

The George Farr Farm at 158 North Main Street is a two-story tall, five-bay wide, two-bay deep, frame private residence constructed circa 1865 in a vernacular style with the appearance of a formal center hall plan. The dwelling consists of a rectangular, side-gabled main block, a two-story ell and a two-story hipped roof addition to the rear (southwest), a one-story shed roof addition extending from the southwest elevation of the ell, and a one-story enclosed porch extending from the southeast elevation of the ell. The roof is sheathed with slate shingles on the main block and asphalt shingles on the rear additions. Interior brick chimneys pierce the roof at the northeast and southwest gable ends of the main block. The dwelling features a molded wood cornice with a return cornice at the northeast and southwest gable ends. The exterior of the dwelling is clad in aluminum siding on all elevations. Windows on the front elevation are two-over-two, double-hung, replacement wood-sash windows with molded surrounds and molded wood lintels. Inoperable louvered shutters flank the windows. The central entrance consists of paired one-light, one-panel doors topped by a segmented, rectangular transom with a floral stained glass design. The doors are set within a molded wood surround. A one-story, hipped roof porch that wraps around from the front elevation to the southwest elevation shelters the entrance. The porch has Ionic columns set on rusticated concrete block piers and a low railing with thin wood balusters. A narrow louvered window with a molded wood lintel sits in the southwest gable end of the main block. Windows on the southwest elevation of the main block and the rear ell are two-over-two, double-hung, replacement wood-sash windows with molded wood surrounds, molded wood lintels, and inoperable louvered shutters. The enclosed porch on the first floor of the rear ell has metal screen windows and a metal screen door. The rear elevation is not visible from the public right-of-way. A narrow louvered

Survey Name: Cranbury CLG Survey 2017

Surveyor: Kristen Herrick

Organization: RGA, Inc.

Property ID:

-1236494288

Page 1

(Primary Contact)

window sits in the northeast gable end of the main block. Windows on the northeast elevation of the main block, the rear ell, and the two-story hipped roof addition are two-over-two, double-hung, replacement wood-sash windows with molded wood surrounds, molded wood lintels, and inoperable louvered shutters. Character-defining elements of the dwelling include the interior gable end brick chimneys and the one-story wraparound porch with Ionic columns.

The property contains three outbuildings, located east of the dwelling: a large one-story frame barn with wood plank siding and a standing seam metal roof, and two smaller one-story frame sheds with wood plank siding and standing seam metal roofs. All three outbuildings date to circa 1930.

History: The George Farr Farm at 158 North Main Street was originally a horse farm and later grew produce and flowers (Cranbury Historical and Preservation Society n.d.) According to historic aerial photographs, the hipped roof addition was constructed circa 1952 and the enclosed porch was constructed circa 1975.

Setting:

The George Farr Farm at 158 North Main Street is sited on a rectangular parcel (Block 26, Lot 30) located on the east side of North Main Street in Cranbury Township, Middlesex County, New Jersey. The dwelling is oriented with its primary elevation facing northwest and is set back approximately 50 feet from North Main Street. A concrete sidewalk spans the west side of the parcel. A paved driveway leads east from North Main Street to three outbuildings located west of the dwelling. The property is lightly wooded. The George Farr Farm at 158 North Main Street is located at the northern edge of the Cranbury Historic District surrounded by other residential properties dating from the mid-nineteenth to the late twentieth centuries. Preserved farmland is located west of the parcel.

Registration and Status Dates:

National Historic Landmark?:
National Register: 9/18/1980
New Jersey Register: 8/9/1979
Determination of Eligibility: 3/25/1977
Certification of Eligibility:

SHPO Opinion:
Local Designation: 9/26/1988
Other Designation:
Other Designation Date:

Eligibility Worksheet included in present survey? Is this Property an identifiable farm or former farm?

Location Map:

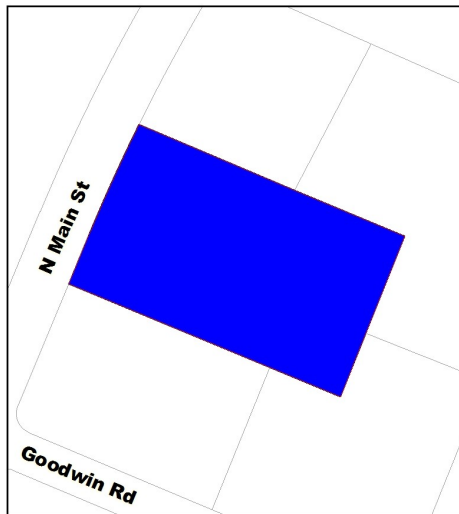

Site Map:

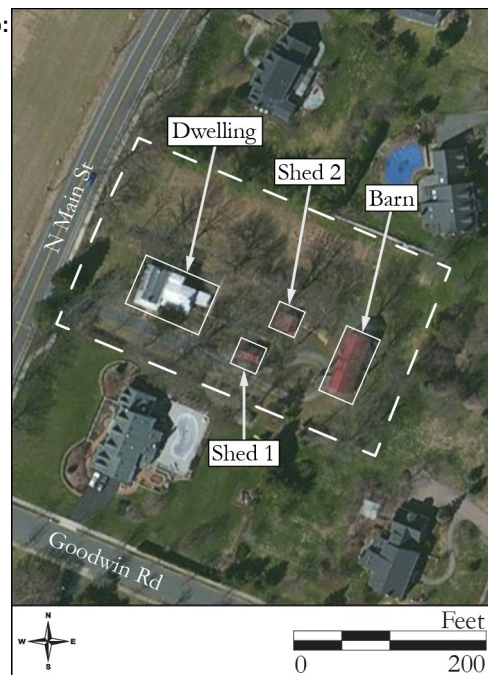

BIBLIOGRAPHY:

Author:	Title:	Year:	HPO Accession #: (if applicable)
Walsh, Ruth	National Register of Historic Places Nomination for the Cranbury Historic District, Cranbury Township, Middlesex County, New Jersey	1979	
Heritage Studies	Preserving Historic Cranbury Village	1989	

Survey Name: Cranbury CLG Survey 2017

Surveyor: Kristen Herrick

Organization: RGA, Inc.

Property ID:

-1236494288

(Primary Contact)

Cranbury Historical and Preservation Society Property File, 158 North Main Street

Additional Information:

The 1989 Heritage Studies survey found that the George Farr Farm at 158 North Main Street is a contributing resource to the Cranbury Historic District. RGA concurs with the previous evaluation and recommends the George Farr Farm at 158 North Main Street as a contributing resource due to its date of construction and design.

More Research Needed? (checked=Yes)

INTENSIVE-LEVEL USE ONLY:

Attachments Included:	0 Building	0 Bridge
	0 Structure	0 Landscape
	0 Object	0 Industry

Historic District ?

District Name: Cranbury Historic District

Status: Contributing

Associated Archeological Site/Deposits?

(known or potential sites. If Yes, please describe briefly)

Conversion Problem? ConversionNote: 17

Date form completed: 7/25/2017

Survey Name: Cranbury CLG Survey 2017

Surveyor: Kristen Herrick

Organization: RGA, Inc.

Property ID:

-1236494288

(Primary Contact)