

History: The property is not shown on the 1916 Sanborn Atlas. The Sanborn Atlas of 1933 shows the house as a T-shaped frame building with a wider front porch and a small addition to the southwest. The detached garage is not shown on the Sanborn of 1933; it first clearly appears on historic aerials in 1979, but the aerials of 1963 and 1970 may show it. The historic aerials are difficult to interpret for this property in the mid-twentieth century. The addition on the rear of the house is first clearly depicted in historic aerial photography in 1979.

Setting:

110 North Main Street is sited on a rectangular parcel (Block 26.01, Lot 17.01) located east side of North Main Street in Cranbury Township, Middlesex County, New Jersey. The dwelling is oriented with its primary elevation facing northwest and is set back approximately 15 feet from North Main Street. A concrete sidewalk spans the west side of the parcel. A paved driveway leads east from North Main Street to the property's lightly wooded backyard. A one-story frame shed is located east of the dwelling. 110 North Main Street is located in a primarily residential neighborhood surrounded by residential properties dating from the mid-nineteenth to the early twentieth centuries.

Registration and Status Dates:

National Historic Landmark?:

National Register: 9/18/1980

New Jersey Register: 8/9/1979

Determination of Eligibility: 3/25/1977

Certification of Eligibility:

SHPO Opinion:

Local Designation: 9/26/1988

Other Designation:

Other Designation Date:

Eligibility Worksheet included in present survey?

Is this Property an identifiable farm or former farm?

Location Map:

Site Map:

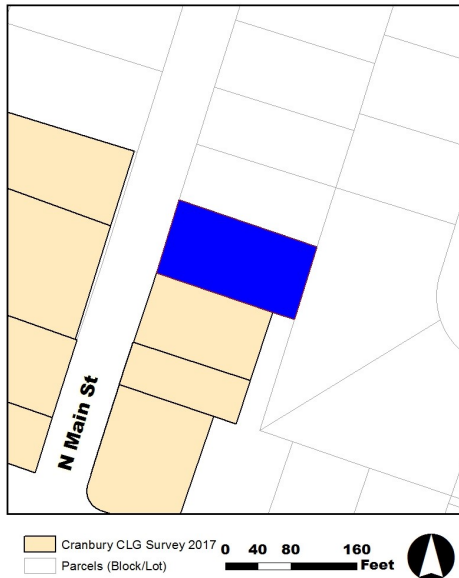

BIBLIOGRAPHY:

Author:	Title:	Year:	HPO Accession #: (if applicable)
Walsh, Ruth	National Register of Historic Places Nomination for the Cranbury Historic District, Cranbury Township, Middlesex County, New Jersey	1979	
Heritage Studies	Preserving Historic Cranbury Village	1989	

Additional Information:

The 1989 Heritage Studies survey identified 110 North Main Street as a contributing resource to the Cranbury Historic District. However, the subject dwelling has since undergone extensive alterations. Therefore, RGA recommends 110 North Main Street as a non-contributing resource to the district.

Survey Name: Cranbury CLG Survey 2017

Surveyor: Kristen Herrick

Organization: RGA, Inc.

Property ID:

Page 2

(Primary Contact)

1778099796

