

# PROPERTY REPORT

Property ID: **770447969**

**Property Name:** 114 North Main Street **Ownership:** Private  
**Address:** 114 N Main ST **Apartment #:** **ZIP:** 08512

## PROPERTY LOCATION(S):

County:	Municipality:	Local Place Name:	USGS Quad:	Block:	Lot:
MIDDLESEX	Cranbury township	Cranbury	Hightstown	26.01	19

## Property Photo:



**Old HSI Number:**

**NRIS Number:**

**HABS/HAER Number:**

## Description:

114 North Main Street is a one-story-tall, four-bay-wide, five-bay-deep, masonry dwelling constructed circa 1952 in the Minimal Traditional style. The dwelling consists of a front-gabled main block with a one-story, hipped-roof wing that adjoins the rear (southeast) elevation; a one-story, side-gabled, enclosed porch to the southwest (added circa 1960); and a small, one-story addition at the northwest corner of the main block that contains a garage (added circa 1960). The roof is covered with asphalt shingles throughout. The primary (northwest) and southwest gable ends are clad in wood shingles (likely original), with vinyl siding on the southwest enclosed porch. Windows throughout are generally six-over-one, double-hung, wood-sash windows, set into wood surrounds with brick lintels (likely original). The primary (northwest) elevation has asymmetrical fenestration, with a wood, roll-top door in the northwest garage wing, a wood-sash window on the main block, and a full-height, fixed-pane window on the southwest enclosed porch. The primary entrance is located on the southwest enclosed porch and contains a glazed vinyl storm door. The northeast elevation of the main block and the southeast wing have symmetrical fenestration with wood-sash windows. A secondary entrance, containing a glazed vinyl storm door, is located in the northeasternmost bay of the main block. The southwest elevation is largely obscured by vegetation, with full-height, fixed-pane windows visible on the southwest enclosed porch. The rear (southeast) elevation is not visible from the public right-of-way.

**History:** 114 North Main Street was constructed circa 1952 and is an example of a mid-twentieth century, Minimal Traditional-style dwelling in Cranbury. In 1951, the subject property was purchased by Russell and Margaret Davison as an empty lot, and the subject dwelling was likely built for them shortly thereafter (Middlesex County Clerk's Office 1951 Deed Book 1583:307). The subject dwelling first appears on a 1953 aerial photograph and is depicted in nearly its current footprint (Nationwide Environmental Title Research [NETR] 1947, 1953). Around 1960, a one-story, enclosed porch was built on the southwest elevation of the main block, and a one-story wing was added to the northwest corner of the main block (NETR 1957, 1963). Little to no alterations occurred to the subject dwelling between the mid-1960s and the late 1980s (NETR 1969, 1979, 1987). Minimal changes have occurred to the dwelling in recent years (NETR 2002, 2019).

## Setting:

114 North Main Street is sited on a roughly rectangular-shaped parcel (Block 26.01, Lot 19) located on the southeast side of North Main Street in Cranbury Township, Middlesex County, New Jersey. The dwelling is oriented with its primary elevation facing northwest and is set back approximately 44 feet from the road. An asphalt-paved driveway extends from North Main Street and connects to the attached garage. Mature trees and shrubs are planted within close proximity to the dwelling. The subject dwelling is located in a residential

**Survey Name:** Cranbury Historic Sites Survey Phase III

**Surveyor:** Spencer Rubino

**Organization:** Richard Grubb & Associates, Inc.

(Primary Contact)

**Property ID:**

**770447969**

Page 1

neighborhood surrounded by properties generally dating from the mid-nineteenth to the late twentieth centuries.

**Registration and Status Dates:**

**National Historic Landmark?:**

**National Register:** 9/18/1980

**New Jersey Register:** 8/9/1979

**Determination of Eligibility:** 3/25/1977

**Certification of Eligibility:**

**SHPO Opinion:**

**Local Designation:** 9/26/1988

**Other Designation:**

**Other Designation Date:**

**Eligibility Worksheet included in present survey?**

**Is this Property an identifiable farm or former farm?**

**Location Map:**

**Site Map:**

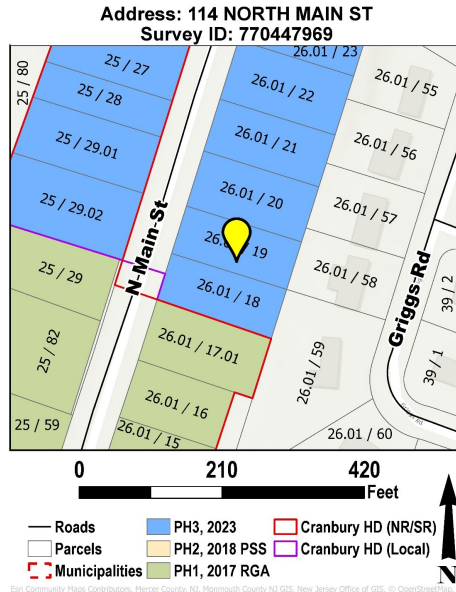

**BIBLIOGRAPHY:**

Author:	Title:	Year:	HPO Accession #: (if applicable)
Heritage Studies	Preserving Historic Cranbury Village. Prepared for the Cranbury Township Historic Preservation Advisory Committee.	1989	
Middlesex County Clerk's Office	On file, Middlesex County Clerk's Office, New Brunswick, New Jersey.		
Nationwide Environmental Title Research (NETR)	Historic Aerial Photograph. Electronic document, <a href="https://www.historicaerials.com">https://www.historicaerials.com</a> , accessed May 2023.	1947	
Nationwide Environmental Title Research (NETR)	Historic Aerial Photograph. Electronic document, <a href="https://www.historicaerials.com">https://www.historicaerials.com</a> , accessed May 2023.	1953	
Nationwide Environmental Title Research (NETR)	Historic Aerial Photograph. Electronic document, <a href="https://www.historicaerials.com">https://www.historicaerials.com</a> , accessed May 2023.	1957	
Nationwide Environmental Title Research (NETR)	Historic Aerial Photograph. Electronic document, <a href="https://www.historicaerials.com">https://www.historicaerials.com</a> , accessed May 2023.	1963	
Nationwide Environmental Title Research (NETR)	Historic Aerial Photograph. Electronic document, <a href="https://www.historicaerials.com">https://www.historicaerials.com</a> , accessed May 2023.	1969	
Nationwide Environmental Title Research (NETR)	Historic Aerial Photograph. Electronic document, <a href="https://www.historicaerials.com">https://www.historicaerials.com</a> , accessed May 2023.	1979	
Nationwide Environmental Title Research (NETR)	Historic Aerial Photograph. Electronic document, <a href="https://www.historicaerials.com">https://www.historicaerials.com</a> , accessed May 2023.	1987	
Nationwide Environmental Title Research (NETR)	Historic Aerial Photograph. Electronic document, <a href="https://www.historicaerials.com">https://www.historicaerials.com</a> , accessed May 2023.	2002	

**Survey Name:** Cranbury Historic Sites Survey Phase III

**Surveyor:** Spencer Rubino

**Organization:** Richard Grubb & Associates, Inc.

(Primary Contact)

**Property ID:**

**770447969**

Page 2

Research (NETR)

Nationwide Environmental Title Research (NETR) Historic Aerial Photograph. Electronic document, 2019 https://www.historicaerials.com, accessed May 2023.

Walsh, Ruth National Register of Historic Places Nomination Form for the Cranbury Historic District, Township of Cranbury, Middlesex County, New Jersey. On file, New Jersey Historic Preservation Office, Trenton, New Jersey. 1980

**Additional Information:**

Although the dwelling at 114 North Main Street was not identified in the 1980 Cranbury Historic District National Register of Historic Places nomination, it was evaluated as a non-contributing (intrusion) resource in the 1989 Heritage Studies inventory of the district (Walsh 1980; Heritage Studies 1989). Richard Grubb & Associates, Inc. recommends 114 North Main Street as a non-contributing resource to the Cranbury Historic District due to its date of construction.

**More Research Needed?**  (checked=Yes)

---

**INTENSIVE-LEVEL USE ONLY:**

**Attachments Included:** 0 Building 0 Bridge  
0 Structure 0 Landscape  
0 Object 0 Industry

**Historic District ?**

**District Name:** Cranbury Historic District

**Status:** Non Contributing

**Associated Archeological Site/Deposits?**

(known or potential sites. If Yes, please describe briefly)

---

Conversion Problem?  ConversionNote: 1202\_26.01\_19

Date form completed: 6/21/2023

---

**Survey Name:** Cranbury Historic Sites Survey Phase III

**Surveyor:** Spencer Rubino

**Organization:** Richard Grubb & Associates, Inc.

(Primary Contact)

**Property ID:**

**770447969**

Page 3



**PROPERTY REPORT: PHOTO CONTINUATION SHEET**

Property ID: **770447969**

**Property Name:** 114 North Main Street

**Address:** 114 N Main ST



*Photo 2*



*Photo 3*