

# PROPERTY REPORT

Property ID: **-1718905672**

**Property Name:** 122 North Main Street **Ownership:** Private  
**Address:** 122 N Main ST **Apartment #:** **ZIP:** 08512

**PROPERTY LOCATION(S):**

| County:   | Municipality:     | Local Place Name: | USGS Quad: | Block: | Lot: |
|-----------|-------------------|-------------------|------------|--------|------|
| MIDDLESEX | Cranbury township | Cranbury          | Hightstown | 26.01  | 23   |

**Property Photo:**



**Old HSI Number:** **NRIS Number:** **HABS/HAER Number:**

**Description:**

122 North Main Street is a two-story-tall, three bay-wide, two-bay-deep, frame dwelling constructed circa 1950 in the Colonial Revival style. The dwelling consists of a side-gabled main block with a one-story, side-gabled southwest wing and a two-story, cross-gable northeast addition (constructed circa 2017). Asphalt shingles covers the roof throughout. An exterior, brick chimney is centered on the southwest elevation of the main block. The dwelling is clad in vinyl siding. Windows are generally six-over-six or one-over-one, vinyl-sash replacement units flanked by operable, paneled wood shutters. The primary (northwest) elevation of the main block has symmetrical fenestration with a central primary entrance, containing a six-light, paneled wood door with segmented sidelights. Sheltering the entrance is a one-bay-wide, flat-roof portico with square wood posts and a brick stoop with stone coping. The northeast and southwest elevations of the main block both have asymmetrical fenestration. The southwest wing contains grouped vinyl-sash windows centered on its southwest elevation, while its northwest elevation is devoid of openings. The northeast addition has asymmetrical fenestration on its northeast elevation, with a shed-roof bay window pierces the east bay on the first floor. The rear (southeast) elevation was not visible from the public right-of-way. The dwelling stands on a brick foundation.

A circa-1950 one-story-tall, one-bay-wide, frame garage stands southeast of the dwelling. The garage is capped by a side-gabled, asphalt-shingle roof with a small wood cupola with a weathervane. The exterior of the garage is clad in vinyl siding. The primary (northwest) elevation contains a paneled wood, roll-top door with faux strap hinges.

History: 122 North Main Street was constructed circa 1950 and is an example of a mid-twentieth-century, Colonial Revival-style dwelling in Cranbury. In 1946, William and Edna Zimmer purchased the subject parcel from Manuel and Lillian Enus (Middlesex County Clerk's Office 1946 Deed Book 1304:443). The dwelling does not appear on a 1947 aerial photograph of North Main Street, indicating that the Zimmers did not immediately build the subject dwelling upon purchasing the land (Nationwide Environmental Title Research [NETR] 1947). The 1950 federal census lists William, Edna, and their two sons as residents of Cranbury, with William employed as a machinist in the radio industry (United States Bureau of the Census 1950). The subject dwelling first appears on a 1953 aerial photograph in nearly its current footprint, accompanied by the extant garage (NETR 1953). No alterations were made to the dwelling's footprint between its construction and the late 1980s (NETR 1970, 1979, 1987). Between 1995 and 2002, a one-story, northeast addition was built, and later expanded to two stories around 2017 (NETR 2002; NJ Geoweb 2015; Google 2019). A two-story, side-gabled addition was also constructed on the southeast elevation of the northeast addition circa 2017 (NJ Geoweb 2015; Google 2019). Between 2013 and 2019, the house and garage

**Survey Name:** Cranbury Historic Sites Survey Phase III

**Surveyor:** Spencer Rubino

**Organization:** Richard Grubb & Associates, Inc.

(Primary Contact)

**Property ID:**

**-1718905672**

Page 1

were both reclad in vinyl siding, all shutters were replaced with the extant paneled wood shutters, and a portico was added to the primary entrance (Google 2013, 2019).

**Setting:**

122 North Main Street is sited on a rectangular parcel (Block 26.01, Lot 23) located on the southeast side of North Main Street in Cranbury Township, Middlesex County, New Jersey. The dwelling is oriented with its primary elevation facing northwest and is set back approximately 50 feet from the road. A concrete driveway extends from North Main Street and leads to the detached garage. Mature trees and shrubs are planted within close proximity to the dwelling. The subject dwelling is located in a residential neighborhood surrounded by properties generally dating from the mid-nineteenth to the late twentieth centuries.

**Registration and Status Dates:**

National Historic Landmark?:

National Register: 9/18/1980

New Jersey Register: 8/9/1979

Determination of Eligibility: 3/25/1977

Certification of Eligibility:

SHPO Opinion:

Local Designation: 9/26/1988

Other Designation:

Other Designation Date:

Eligibility Worksheet included in present survey?

Is this Property an identifiable farm or former farm?

**Location Map:**

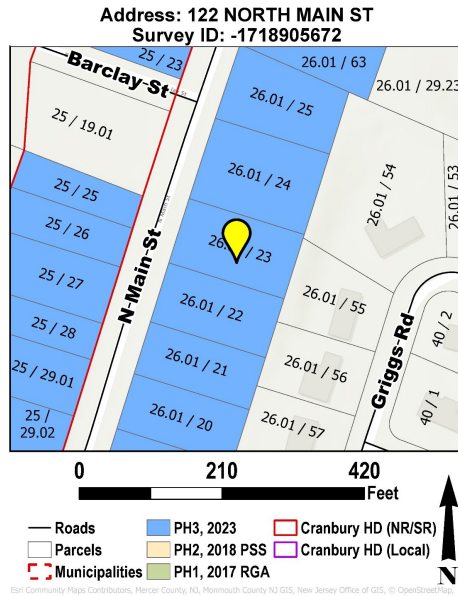

**Site Map:**

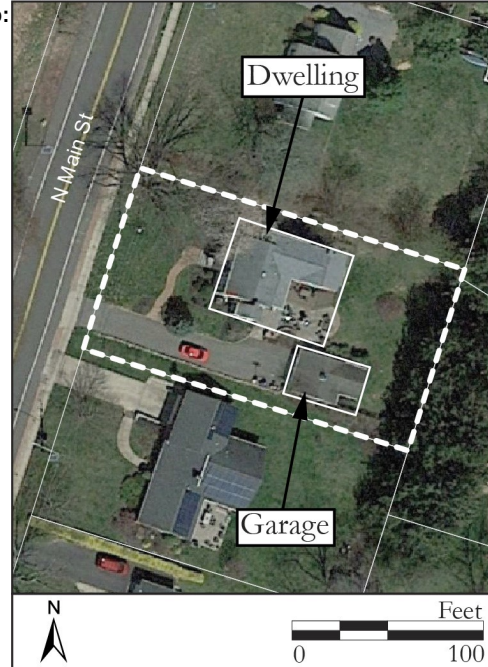

**BIBLIOGRAPHY:**

| Author:  | Title:  | Year: | HPO Accession #: (if applicable) |
|--|---|-------|----------------------------------|
| Google   | Google Street View. Electronic document, <a href="https://www.google.com/maps/">https://www.google.com/maps/</a> , accessed May 2023.               | 2013  |                                  |
| Google   | Google Earth Aerial. Electronic document, <a href="https://earth.google.com/web/">https://earth.google.com/web/</a> , accessed May 2023.            | 2019  |                                  |
| Heritage Studies                               | Preserving Historic Cranbury Village. Prepared for the Cranbury Township Historic Preservation Advisory Committee.                                  | 1989  |                                  |
| Middlesex County Clerk's Office [MCCO]         | On file, Middlesex County Clerk's Office, New Brunswick, New Jersey.  |       |                                  |
| Nationwide Environmental Title Research (NETR) | Historic Aerial Photograph. Electronic document, <a href="https://www.historicaerials.com">https://www.historicaerials.com</a> , accessed May 2023. | 1947  |                                  |
| Nationwide Environmental Title Research (NETR) | Historic Aerial Photograph. Electronic document, <a href="https://www.historicaerials.com">https://www.historicaerials.com</a> , accessed May 2023. | 1953  |                                  |
| Nationwide Environmental Title Research (NETR) | Historic Aerial Photograph. Electronic document, <a href="https://www.historicaerials.com">https://www.historicaerials.com</a> , accessed May 2023. | 1970  |                                  |
| Nationwide Environmental Title Research (NETR) | Historic Aerial Photograph. Electronic document, <a href="https://www.historicaerials.com">https://www.historicaerials.com</a> , accessed May 2023. | 1979  |                                  |

**Survey Name:** Cranbury Historic Sites Survey Phase III

**Surveyor:** Spencer Rubino

**Organization:** Richard Grubb & Associates, Inc.

(Primary Contact)

**Property ID:**

**-1718905672**

Page 2

|  |   |      |
|--|---|------|
| Nationwide Environmental Title Research (NETR) | Historic Aerial Photograph. Electronic document, <a href="https://www.historicaerials.com">https://www.historicaerials.com</a> , accessed May 2023.   | 1987 |
| Nationwide Environmental Title Research (NETR) | Historic Aerial Photograph. Electronic document, <a href="https://www.historicaerials.com">https://www.historicaerials.com</a> , accessed May 2023.   | 1995 |
| Nationwide Environmental Title Research (NETR) | Historic Aerial Photograph. Electronic document, <a href="https://www.historicaerials.com">https://www.historicaerials.com</a> , accessed May 2023.   | 2002 |
| NJ Geoweb                                      | Aerial Image. Electronic document, <a href="https://njdep.maps.arcgis.com/apps/webappviewer/">https://njdep.maps.arcgis.com/apps/webappviewer/</a> , accessed June 2023.  | 2015 |
| United States Bureau of the Census             | Population Schedule, Cranbury Township, Middlesex County, New Jersey.   | 1950 |
| Walsh, Ruth                                    | National Register of Historic Places Nomination Form for the Cranbury Historic District, Township of Cranbury, Middlesex County, New Jersey. On file, New Jersey Historic Preservation Office, Trenton, New Jersey. | 1980 |

**Additional Information:**

Although the dwelling at 120 North Main Street was not identified in the 1980 Cranbury Historic District National Register of Historic Places nomination form, it was evaluated as a non-contributing (intrusion) resource in the 1989 Heritage Studies inventory of the district (Walsh 1980; Heritage Studies 1989). Richard Grubb & Associates, Inc. recommends 120 North Main Street as a non-contributing resource to the Cranbury Historic District due to its date of construction.

**More Research Needed?**     (checked=Yes)

**INTENSIVE-LEVEL USE ONLY:**

**Attachments Included:**

|             |             |
|-------------|-------------|
| 0 Building  | 0 Bridge    |
| 0 Structure | 0 Landscape |
| 0 Object    | 0 Industry  |

**Historic District ?**   

**District Name:** Cranbury Historic District

**Status:** Non Contributing

**Associated Archeological Site/Deposits?**   

(known or potential sites. If Yes, please describe briefly)

Conversion Problem?        ConversionNote:    1202\_26.01\_23

*Date form completed:*    6/21/2023

**Survey Name:** Cranbury Historic Sites Survey Phase III

**Surveyor:** Spencer Rubino

**Organization:** Richard Grubb & Associates, Inc.

(Primary Contact)

**Property ID:**

**-1718905672**

Page 3



**PROPERTY REPORT: PHOTO CONTINUATION SHEET**

Property ID: **-1718905672**

**Property Name:** 122 North Main Street

**Address:** 122 N Main ST



*Photo 2*



*Photo 3*