

element of the dwelling. A one-story, side-gabled frame shed (built circa 2015) is located to the rear of the dwelling.

History: 50 North Main Street first appears cartographically on the 1872 Beers atlas, owned by "D. Measurall." The 1876 Everts and Stewart map shows no changes in ownership. The 1916 Sanborn map shows the subject dwelling as a two-story frame dwelling with a one-story wraparound porch, a two-story rear addition, a one-story porch on the southwest elevation, and a one-story frame outbuilding adjoining the southeast corner. The 1933 Sanborn map shows no changes to the subject dwelling. According to historic aerial photographs, the one-story porch on the southwest elevation was removed circa 2007 and the one-story frame outbuilding was demolished circa 2012. 50 North Main Street served as the Cranbury Gift Shop in the late-twentieth century.

Setting:

50 North Main Street is sited on a rectangular parcel (Block 32, Lot 2) located on the east side of North Main Street in Cranbury Township, Middlesex County, New Jersey. The dwelling is oriented with its primary elevation facing northeast and is set back approximately 10 feet from North Main Street. A concrete sidewalk, which runs along North Main Street, spans the west side of the parcel. A paved driveway leads west past the northwest elevation of the dwelling to a one-story frame shed. The backyard is enclosed by a wood fence. Perennial plantings about the front (northwest) elevation. 50 North Main Street is located in a mixed residential and commercial neighborhood surrounded by properties dating from the mid-nineteenth to the early twentieth century.

Registration and Status Dates:

National Historic Landmark?:

National Register: 9/18/1980

New Jersey Register: 8/9/1979

Determination of Eligibility: 3/25/1977

Certification of Eligibility:

SHPO Opinion:

Local Designation: 9/26/1988

Other Designation:

Other Designation Date:

Eligibility Worksheet included in present survey?

Is this Property an identifiable farm or former farm?

Location Map:

Site Map:

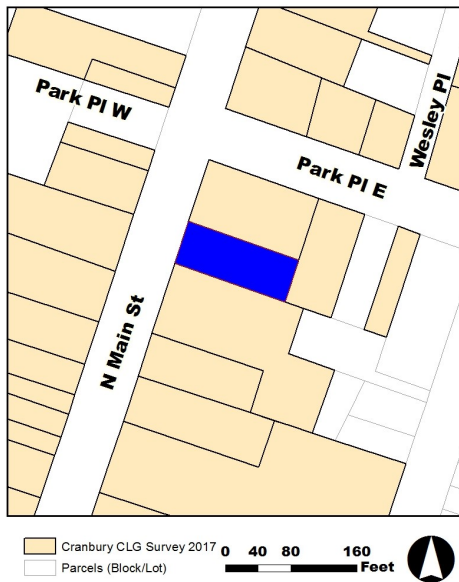

BIBLIOGRAPHY:

Author:	Title:	Year:	HPO Accession #:
Walsh, Ruth	National Register of Historic Places Nomination for the Cranbury Historic District, Cranbury Township, Middlesex County, New Jersey	1979	(if applicable)
Heritage Studies	Preserving Historic Cranbury Village	1989	

Additional Information:

Survey Name: Cranbury CLG Survey 2017

Surveyor: Kristen Herrick

Organization: RGA, Inc.

Property ID:

Page 2

(Primary Contact)

2117452849

