

PROPERTY REPORT

Property ID: **-2132910073**

Property Name: 8 Park Place East **Ownership:** Private
Address: 8 Park PL E **Apartment #:** **ZIP:** 08512

PROPERTY LOCATION(S):

County:	Municipality:	Local Place Name:	USGS Quad:	Block:	Lot:
MIDDLESEX	Cranbury township	Cranbury	Hightstown	32	22

Property Photo:



Old HSI Number:

NRIS Number:

HABS/HAER Number:

Description:

8 Park Place East is a two-story tall, three-bay wide, two-bay deep, frame private residence constructed circa 1870. The dwelling, which has a stucco foundation, consists of a rectangular, side-gabled main block; a one-story, two-bay ell and a one-story enclosed porch (constructed circa 1910); and a one-story rear wing (added circa 2000). The roof is sheathed with asphalt shingles. The exterior of the dwelling is clad in wood clapboard siding on the main block with vinyl siding on all additions. A brick interior chimney pierces the roof at the northwest gable end of the main block. Regular fenestration on the front elevation consists of six-over-six, double-hung, wood-sash windows with louvered shutters. The entrance, located in the east bay, is a two-panel wood door with a wood screen door, topped by a rectangular, three-light transom. Access is gained via a brick stoop with wrought iron railings, sheltered by an oversized arcuated, gabled hood. On the northwest elevation, louvered windows sit in the gable end of the main block with six-over-six, double-hung, wood-sash windows with louvered shutters on the first and second floors. The enclosed porch has six-over-six, double-hung, wood-sash windows with paired one-over-one, vinyl-sash windows on the rear wing. Louvered windows also sit in the southeast gable end of the main block with a six-over-six, double-hung, wood-sash window with louvered shutters on the first floor. Windows on the one-story ell are paired six-over-six, double-hung, wood-sash. Character-defining elements of the dwelling include louvered shutters and an interior gable end brick chimney. A one-story, front-gabled stucco garage stands at the rear of the property.

History: 8 Park Place East first appears cartographically on the 1872 Beers atlas, owned by "C.W.R." The 1876 Everts and Stewart map

Survey Name: Cranbury CLG Survey 2017

Surveyor: Kristen Herrick

Organization: RGA, Inc.

Property ID:

Page 1

(Primary Contact)

-2132910073

indicates no changes in ownership. The 1912 Sanborn map shows the subject dwelling as a two-story frame dwelling with a one-story rear addition and a one-story L-shaped addition. The 1933 Sanborn map indicates no further changes. According to historic aerial photographs, the one-story garage was constructed by 1960 and the large rear wing was added to the dwelling circa 2000.

Setting:

8 Park Place East is sited on a rectangular parcel (Block 32, Lot 22) located on the south side of Park Place East in Cranbury Township, Middlesex County, New Jersey. The dwelling is located with its primary elevation facing northeast and is set back approximately 10 feet from Park Place East. A concrete sidewalk, which runs along the south side of Park Place East, spans the entire north side of the parcel. The property is lightly wooded with perennial plantings abutting the front elevation of the dwelling. 8 Park Place East is located in a primarily residential neighborhood surrounded by residential properties dating from the mid-nineteenth to the early twentieth century.

Registration and Status Dates:

National Historic Landmark?:
National Register: 9/18/1980
New Jersey Register: 8/9/1979
Determination of Eligibility: 3/25/1977
Certification of Eligibility:

SHPO Opinion:
Local Designation: 9/26/1988
Other Designation:
Other Designation Date:

Eligibility Worksheet included in present survey? Is this Property an identifiable farm or former farm?

Location Map:

Site Map:

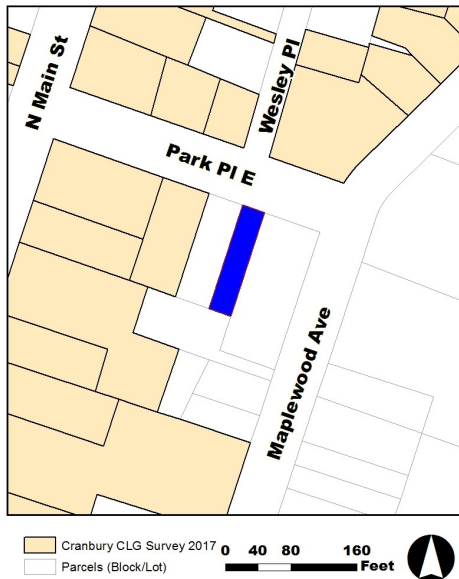

BIBLIOGRAPHY:

Author:	Title:	Year:	HPO Accession #:	(if applicable)
Heritage Studies	Preserving Historic Cranbury Village	1989		
Walsh, Ruth	National Register of Historic Places Nomination for the Cranbury Historic District, Cranbury Township, Middlesex County, New Jersey	1979		

Additional Information:

The 1989 Heritage Studies survey identified 8 Park Place East as a contributing resource to the Cranbury Historic District. RGA concurs with the previous evaluation and recommends 8 Park Place East as a contributing resource due to its date of construction, design, and use of materials compatible with the district.

More Research Needed? (checked=Yes)

Survey Name: Cranbury CLG Survey 2017

Surveyor: Kristen Herrick

Organization: RGA, Inc.

Property ID:

-2132910073

(Primary Contact)

INTENSIVE-LEVEL USE ONLY:

Attachments Included: 0 Building 0 Bridge
 0 Structure 0 Landscape
 0 Object 0 Industry

Historic District ?

District Name: Cranbury Historic District

Status: Contributing

Associated Archeological Site/Deposits?

(known or potential sites. If Yes, please describe briefly)

Conversion Problem? ConversionNote: 20

Date form completed: 6/26/2017

Survey Name: Cranbury CLG Survey 2017

Surveyor: Kristen Herrick

Organization: RGA, Inc.

(Primary Contact)

Property ID:

-2132910073