

PROPERTY REPORT

Property ID: **-566727815**

Property Name: Odd Fellows Hall **Ownership:** Private
Address: 30 N Main ST **Apartment #:** **ZIP:** 08512

PROPERTY LOCATION(S):

County:	Municipality:	Local Place Name:	USGS Quad:	Block:	Lot:
MIDDLESEX	Cranbury township	Cranbury		32	8

Property Photo:



Old HSI Number:

NRIS Number:

HABS/HAER Number:

Description:

Odd Fellows Hall at 30 North Main Street is a two-story-tall, three-bay wide, four-bay deep, frame fraternal building constructed in 1889. The building, which sits on a brick foundation, consists of a rectangular front-gabled main block; a one-story, two-bay addition; and a one-story, one-bay shed roof addition on the rear. The roof is sheathed with asphalt shingles. The exterior of the building is clad in wood clapboard siding on the front elevation and aluminum siding on the side elevations. The front gable end is clad in wood shingles. Paired two-over-two, double-hung, arched wood-sash windows (likely original) with a molded wood lintel sit in the center bay on the second floor. Below the window is a carved datestone that reads "Odd Fellows Hall, erected A.D. 1889." A wood frieze runs above the first floor of the building. Windows on the first floor are a four-over-four, double-hung wood-sash window within a molded surround (likely original) in the north bay and paired one-over-one, double-hung, vinyl-sash replacement windows within a molded surround in the south bay. The central entrance is a single-leaf door with a single pane above a molded panel. The door is flanked by canted sidelights with molded panels and topped by a rectangular transom within a molded wood surround. A brick stoop with six steps and wrought iron railings provides access to the entrance. Windows on the northwest elevation are two-over-two, double-hung, wood-sash (likely original). The rear elevation is not visible from the public right-of-way. Windows on the southeast elevation are also two-over-two, double-hung, wood-sash (likely original).

History: Odd Fellows Hall served as the Cranbury Post Office from around 1910 to 1971, when the post office moved to its present location at 65 North Main Street (Chambers 2012:98). The subject building first appears cartographically on the 1916 Sanborn map of

Survey Name: Cranbury CLG Survey 2017

Surveyor: Kristen Herrick

Organization: RGA, Inc.

Property ID:

-566727815

Page 1

(Primary Contact)

Cranbury Township as a two-story frame building with two one-story rear additions. The building is labeled as the post office with a lodge on the second floor. The 1933 Sanborn map shows no changes.

Setting:

Odd Fellows Hall is sited on a rectangular parcel (Block 32, Lot 8) located on the west side of North Main Street in Cranbury Township, Middlesex County, New Jersey. The building is oriented with its primary elevation facing northwest and is set back approximately 15 feet from North Main Street. A concrete sidewalk, which runs along North Main Street, spans the west side of the parcel. A paved driveway leads east from North Main Street past the northeast elevation of the building to a paved parking lot and a one-story garage. Shrubs adjoin the front (northwest) elevation. Odd Fellows Hall is located in a mixed residential and commercial neighborhood surrounded by properties dating from the mid-nineteenth to the early twentieth century.

Registration and Status Dates:

National Historic Landmark?:
National Register: 9/18/1980
New Jersey Register: 8/9/1979
Determination of Eligibility: 3/25/1977
Certification of Eligibility:

SHPO Opinion:
Local Designation: 9/26/1988
Other Designation:
Other Designation Date:

Eligibility Worksheet included in present survey? Is this Property an identifiable farm or former farm?

Location Map:

Site Map:

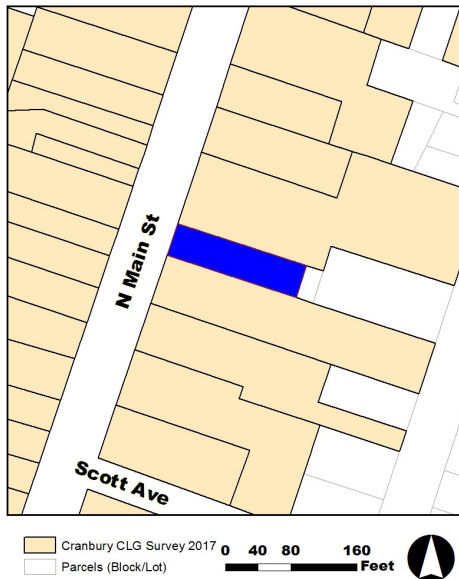

BIBLIOGRAPHY:

Author:	Title:	Year:	HPO Accession #:	(if applicable)
Chambers, John Whiteclay II	Cranbury: A New Jersey Town from the Colonial Era to the Present	2012		
Walsh, Ruth	National Register of Historic Places Nomination for the Cranbury Historic District, Cranbury Township, Middlesex County, New Jersey	1979		
Heritage Studies	Preserving Historic Cranbury Village	1989		

Additional Information:

The 1989 Heritage Studies survey identified Odd Fellows Hall at 30 North Main Street as a contributing resource to the Cranbury Historic District. RGA concurs with the previous evaluation and recommends Odd Fellows Hall at 30 North Main Street as a contributing resource due to its date of construction, design, and use of materials compatible with the district.

Survey Name: Cranbury CLG Survey 2017

Surveyor: Kristen Herrick

Organization: RGA, Inc.

Property ID:

Page 2

(Primary Contact)

-566727815

More Research Needed? (checked=Yes)

INTENSIVE-LEVEL USE ONLY:

Attachments Included:

0 Building	0 Bridge
0 Structure	0 Landscape
0 Object	0 Industry

Historic District ?

District Name: Cranbury Historic District

Status: Contributing

Associated Archeological Site/Deposits?

(known or potential sites. If Yes, please describe briefly)

Conversion Problem? ConversionNote: 10

Date form completed: 6/26/2017

Survey Name: Cranbury CLG Survey 2017

Surveyor: Kristen Herrick

Organization: RGA, Inc.

(Primary Contact)

Property ID:

-566727815

Page 3