

## PROPERTY REPORT

Property ID: **-1949285694**

**Property Name:** Ander Van Kirk House **Ownership:** Private  
**Address:** 5 S MAIN ST **Apartment #:** **ZIP:** 08512

### PROPERTY LOCATION(S):

County:	Municipality:	Local Place Name:	USGS Quad:	Block:	Lot:
MIDDLESEX	Cranbury township			35	1.01

### Property Photo:



**Old HSI Number:** **NRIS Number:** **HABS/HAER Number:** 91

### Description:

PS&S recommends that 5 S. Main Street, which includes a historic residence constructed ca. 1826 and expanded later in the 19th century, and a historic secondary building is a contributing property in the Cranbury Historic District. A garage at the rear of the property, built circa 1980, does not contribute to the property.

The 2-story, side gable-roofed, rectangular-plan main block of this aluminum siding-clad, frame dwelling on a parged foundation is 5 bays wide and 2 bays deep and is fronted on the northwest elevation by a 1-story, composite-roofed, 3-bay wide, centered porch and backed on the southeast elevation by a 2-story, gable-roofed secondary volume offset to the southwest and a 2-story, composite-roofed volume offset to the northeast. The southwest rear volume is backed by a 1-story, shed-roofed, enclosed porch. A 2-story, 3-sided window bay projects from the southwest elevation of the gable-roofed rear volume. The roofs are predominantly clad in asphalt shingle with eave returns at the gable-ends and the windows predominantly have 6/1 replacement sash with applied shutters. An exterior brick chimney projects from the southwest elevation of the main block, and a second exterior brick chimney projects from the northwest bay of the northeast elevation of the composite-roofed rear volume. The front porch on the northwest, main elevation includes replaced Tuscan columns and a replaced rail with square-section balusters. The primary entrance is located in the central bay and includes a historic door with a large, single light and historic single light side lights and transom. The remaining bays of both floors are regularly fenestrated, with a decorative entablature over the windows of the first floor. The southwest elevation of the main volume is lighted by 2 windows flanking the chimney on the first floor

**Survey Name:** Cranbury Local Historic District Survey 2018

**Principal Investigator:** Emily Cooperman

**Organization:** Paulus, Sokolowski & Sartor

**Property ID:**

**-1949285694**

Page 1

(Primary Contact)

and a single window lighting the west bay of the second floor. The 2-story window bay, which includes a projecting eave at the second floor, is lighted by a 3 windows on each floor. The southeast, rear elevation is only partially visible from the public right-of-way and is asymmetrically fenestrated with a secondary entrance in the south bay of the composite-roofed volume. The northeast, side elevation is lighted in the rear volume by 2 windows on the second floor and a smaller double window on the first floor. The main volume is lighted by a single window on each floor of the northwest bay.

The 1 1/2-story, gable-roofed, historic secondary building, only partially visible from the public right-of-way, is located to the east of the residence and includes a historic double door and replaced window on its northwest elevation.

The 1-story, asymmetrically gable-roofed garage is located to the southeast of the secondary building and includes garage doors on the southeast elevation and an entrance and flanking windows on the northwest elevation. A single window with a fan light lights the southwest, side elevation.

Historic maps indicate that South Main Street includes some of the earliest development in Cranbury. The settlement began in 1736 with the construction of a mill on the south banks of the Cranbury Brook and, by 1810, developed into a small village. The 1980 National Register of Historic Places Nomination for the Cranbury Historic District notes that the 2 1/2-story, center hall residence at 5 S. Main Street was constructed circa 1826 for Ander Van Kirk. The nomination also reports that the house retains its historic fan light and sidelights but was enlarged by outer bays on the main volume in the 1860s. This residence may be one of 5 buildings documented on the 1850 Otley and Keiley Map between Brainerd Lake and Station Road. This residence is first documented on the 1876 map as belonging to "Mrs. E. Flemming" and is documented on the 1916 Sanborn map as a 2-story, L-plan dwelling fronted by a full-width porch and backed by a 1-story rear el. A 2-story outbuilding flanked by 1-story volumes is located to the northeast of the residence. The 1933 Sanborn map documents a similar massing of the residence with the addition of a 3-sided projecting bay on the side elevation. The outbuildings in 1933 were a 1-story garage and 1-story shed. The 1974 photographic inventory of Cranbury historic buildings in the collection of the Cranbury Historical and Preservation Society shows the residence with shuttered windows and a front porch across the 3 central bays of the main elevation. The 1989 Heritage Studies Inventory reports that a renovation campaign in the 20th century replaced the front door, door surround, window sash, and Colonial Revival porch. Historic aerial photographs indicate that the historic garage was demolished and replaced by the current garage between 1979 and 1987.

The residence at 5 S. Main Street contributes to the Cranbury Historic District because it retains integrity and historic, character-defining features such as its historic replacement porch, historic replacement door and door surround, historic replacement window sash, and historic chimney, and its historic secondary building.

**Setting:**

South Main Street stretches from Brainerd Lake to the southern edge of Cranbury and is characterized by freestanding single-family residences of moderate scale ranging in date from the early 19th century to the early 20th century.

**Registration and Status Dates:**

**National Historic Landmark?:**

**National Register:** 9/18/1980

**New Jersey Register:** 8/9/1979

**Determination of Eligibility:** 3/25/1977

**Certification of Eligibility:**

**SHPO Opinion:**

**Local Designation:** 9/26/1988

**Other Designation:**

**Other Designation Date:**

**Eligibility Worksheet included in present survey?**

**Is this Property an identifiable farm or former farm?**

**Survey Name:** Cranbury Local Historic District Survey 2018

**Principal Investigator:** Emily Cooperman

**Organization:** Paulus, Sokolowski & Sartor

**Property ID:**

(Primary Contact)

**-1949285694**

Location Map:

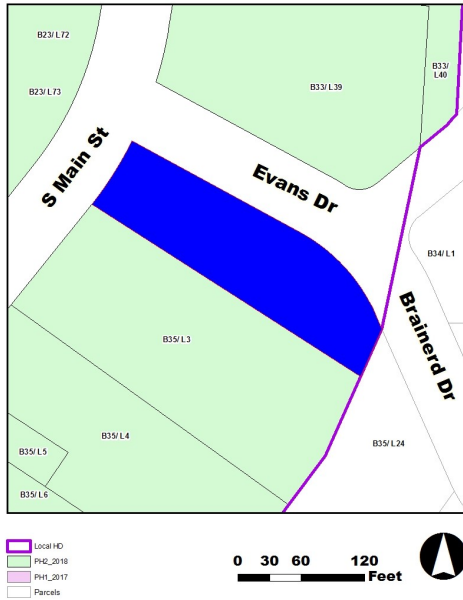

Site Map:



**BIBLIOGRAPHY:**

Author:	Title:	Year:	HPO Accession #:	(if applicable)
(None Listed)	1850 Otley and Keily Map	1850		
Brennan, Peggy and Frank J. Jr.	Images of America: Cranbury	1995		
Brennan, Peggy and Frank J. Jr.	Images of America: Cranbury, Volume II	1998		
(None Listed)	Aerial and street view photography for 1931, 1940, 1947, 1953, 1957, 1963, 1969, 1970, 1972, 1979, 1987, 1995, 2002, 2006, 2007, 2008, 2010, 2012, 2013, and 2015 available at <a href="http://historicaerials.com">historicaerials.com</a> and for 1995, 2002, 2006, 2007, 2008, 2010, 2013, 2016, and 2017 available through Google Earth			
(None Listed)	1916 Sanborn Map	1916		
(None Listed)	1876 Everts and Stewart Map	1876		
(None Listed)	1933 Sanborn Map	1933		
Walsh, Ruth	National Register of Historic Places Nomination for the Cranbury Historic District, Cranbury Township, Middlesex County, New Jersey	1979		
Heritage Studies	Preserving Cranbury Township	1989		
Chambers, John Whiteclay II	Cranbury: A New Jersey Town from the Colonial Era to the Present	2012		

**Additional Information:**

1202\_35\_1.01 / 2STY - SFD / 1840

More Research Needed?  (checked=Yes)

**Survey Name:** Cranbury Local Historic District Survey 2018

**Principal Investigator:** Emily Cooperman

**Organization:** Paulus, Sokolowski & Sartor

**Property ID:**

**-1949285694**

(Primary Contact)

**INTENSIVE-LEVEL USE ONLY:**

**Attachments Included:**            0 Building                            0 Bridge  
   0 Structure                            0 Landscape  
   0 Object                                0 Industry

**Historic District ?**   

**District Name:** Cranbury Historic District

**Status:** Contributing

**Associated Archeological Site/Deposits?**   

(known or potential sites. If Yes, please describe briefly)

---

Conversion Problem?                ConversionNote:

*Date form completed:*            8/24/2018

---

**Survey Name:** Cranbury Local Historic District Survey 2018

**Principal Investigator:** Emily Cooperman

**Organization:** Paulus, Sokolowski & Sartor

**Property ID:**

(Primary Contact)

**-1949285694**